

Helmet Mounting Bracket

Professional grade brackets for any demanding diving application.



FEATURES

Fits the Kirby Morgan Superlite 17 & 27 and the KM 37SS & 77.

Made with 316 Stainless Steel

Multiple hole patterns to accommodate the mounting of almost any lights or cameras.

Mount & dismount your lights & cameras in a flash without the need to use any tools or hardware.

T: (858) 576-1261
F: (858) 576-0219

4033 Ruffin Road
San Diego, CA
92123- 1817 USA

www.deepsea.com
sales@deepsea.com



Helmet Mounting Bracket

Helmet Mounting Bracket for Kirby Morgan Superlite 17 & 27

Made of 316 SS

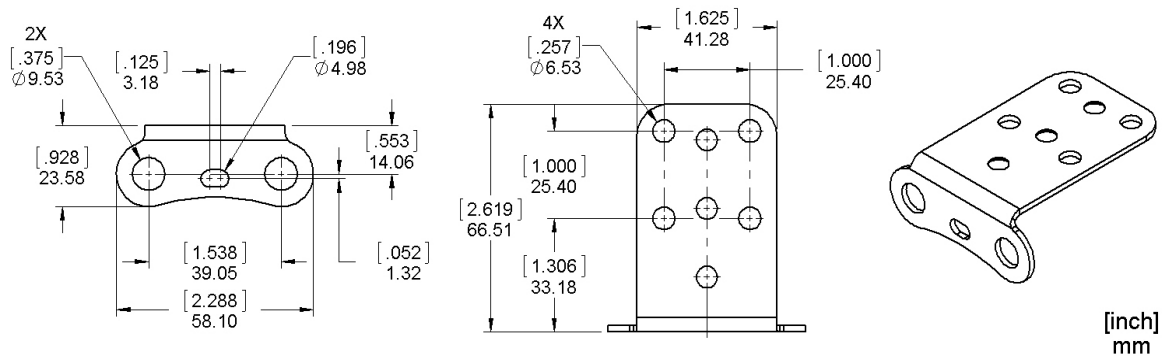

Helmet Mounting Bracket for Kirby Morgan 37 SS and KM 77

Made of 316 SS

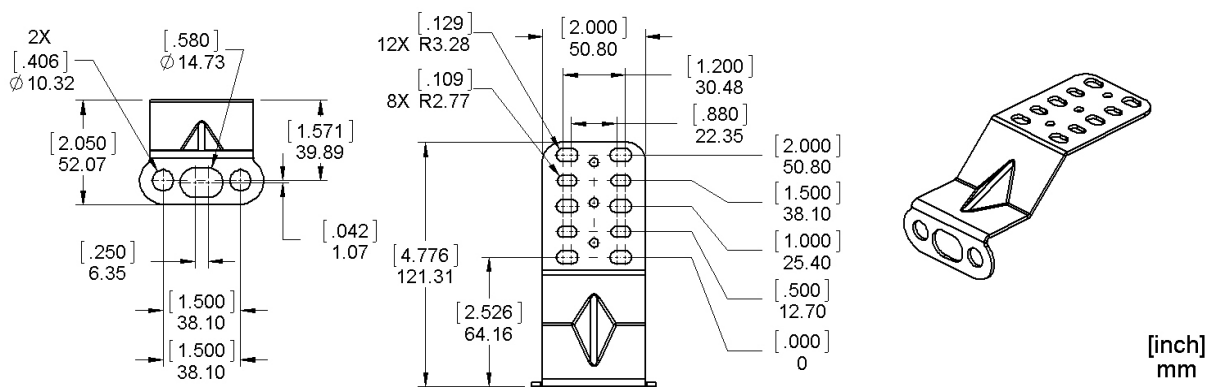

Quick Release Bracket

Bracket: Made of 316 SS

Mounting Block: Made of Glass Reinforced Nylon

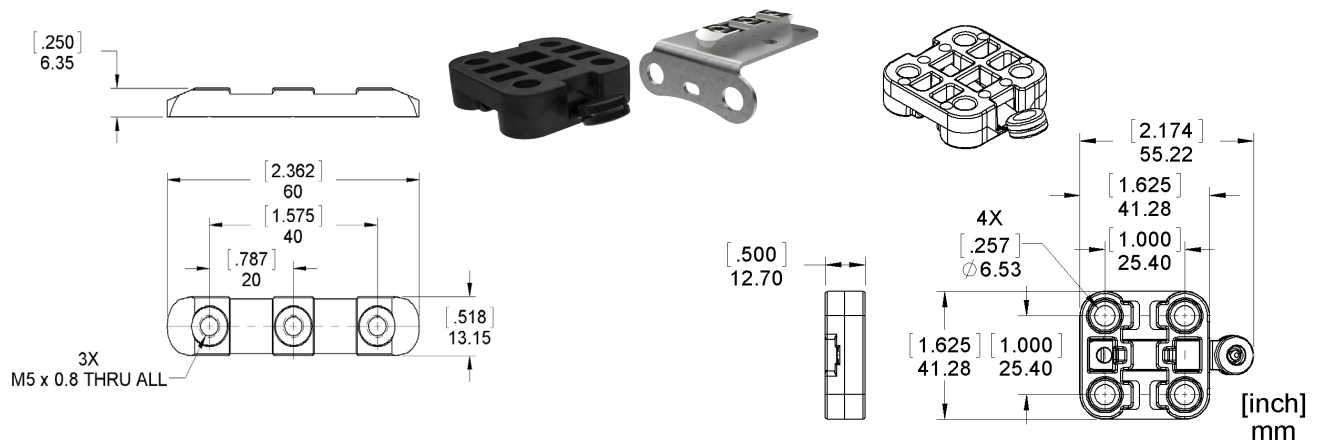

T: (858) 576-1261
F: (858) 576-0219

4033 Ruffin Road
San Diego, CA 92123- 1817 USA

www.deepsea.com
info@deepsea.com

