



# Micro SeaLaser® Dual Mount

- Creates and Maintains Parallel Beams
- Excellent For Scaling and Measurement
- Designed For Use With Micro SeaLaser®



**DEEPSEA**  
Power & Light®

# Micro SeaLaser® Dual Mount Specifications

The Micro SeaLaser Dual Mount is designed to position and hold two Micro SeaLasers forming parallel beams 10cm apart. The dual laser mount is adjusted at the factory using the two pairs of opposing nylon tipped allen screws at the back of the mount. The bracket has four mounting holes to attach the dual mount to an ROV frame, pan-and-tilt, or base unit. The mount has an additional four holes for an optional Multi-SeaCam mounting bracket for a camera view between the two lasers (camera in photo on front is not included with the mount). A manual with instructions for field alignment is included.

Micro SeaLaser® Dual Mount	
<b>MECHANICAL</b>	
Housing Material:	Acetal Plastic (Delrin)
Length:	2.20 cm (0.87 in.) [without SeaLasers] 12.03 cm (4.73 in.) [with ttSeaLasers]
Height:	2.03 cm (0.80 in.)
Width:	5.72 cm (2.25 in.)
<b>OTHER</b>	
Distance Between Beams:	10 cm (3.94 in.)

Top View

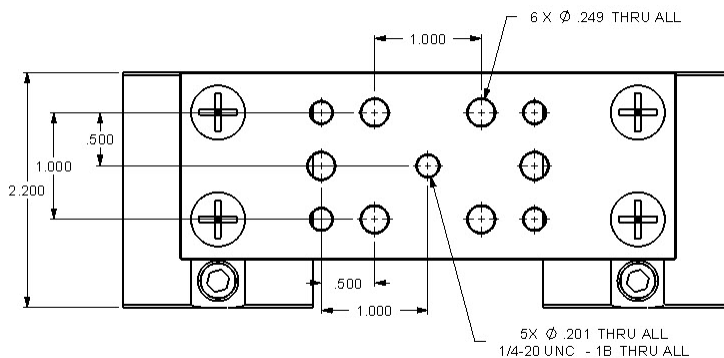

Front View

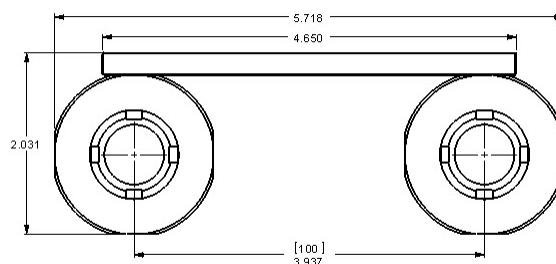

*Specifications subject to change without notice.*

DSPL ENG 718-003,018  
REV 11.30.12



**DEEPSEA**  
Power & Light®

4033 Ruffin Road  
San Diego, CA 92123  
ph: (858) 576-1261

www.deepsea.com  
info@deepsea.com  
fax: (858) 576-0219