

SubConn® HF Coax

50 ohm Coax and Coax/Electric

Connector specifications

Voltage rating on electric contacts	300 V DC/AC rms
Current rating on electric contacts	5 A per contact (max 20 A per connector)
Video types	Recommended for Composite, SDI, HD-SDI and 3G-SDI video

Frequency*	0.3 GHz	0.6 GHz	0.9 GHz	1.2 GHz	1.5 GHz	1.8 GHz	2.1 GHz	2.4 GHz	2.7 GHz	3.0 GHz
Attenuation*	5.0 dB	7.7 dB	9.9 dB	11.6 dB	13.4 dB	15.3 dB	17.3 dB	19.3 dB	21 dB	22.5 dB

Recommended max frequency	3.0 GHz
Insulation resistance	> 200 Mohm
Contact resistance	< 0.01 ohm
Wet matings	N/A (dry mating only)
Temperature rating (water)	- 4 to 60°C, 25 to 140°F
Temperature rating (air)	- 40 to 60°C, - 40 to 140°F
Storage temperature rating	- 40 to 60°C, - 40 to 140°F
Qualified pressure tested	600 bar, 8,700 psi

Material specifications

Connector body	Chloroprene rubber
Bulkhead body	Brass, stainless steel, titanium or anodised aluminium
Power contacts	Female sockets in gold plated brass UNS - C36000
	Male pins in gold plated beryllium copper
Coax contacts	Gold plated contacts
O-rings	Nitrile
Locking sleeves	POM or stainless steel
Snap rings	Stainless steel AISI 302
Inline cable (60 cm, 2 ft)	PUR jacket cable with RG58 coax or RG58 coax and 6 x 20 AWG, 0.52 mm ² conductors
Coax bulkhead leads (100 cm 3.3 ft)	RG316 coax
Coax and 6-contact bulkhead leads (100 cm 3.3 ft)	RG316 coax and 6 x 20 AWG, 0.52 mm ² coloured PTFE wires

Face view (male)

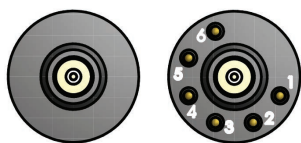

Inline cable colour code

1 Black	3 Red	5 Orange
2 White	4 Green	6 Blue

Nominal cable outside diameter (OD)

RG58 PUR cable 0.230", 5.85 mm
 RG58 and 6-conductor PUR cable 0.385", 9.80 mm

Additional information

*All frequency and attenuation values are based on a 10 meter cable assembly test including 2 bulkhead connectors (50 ohm).
 BNC connector for RG316 coax leads use Amphenol 031-315-RFX or equivalent.
 BNC connector for RG58 coax cable use Amphenol 112116 or equivalent.

SubConn® Coax connectors are dry mate only, and cannot take open face pressure.
 Locking sleeves are required. No greasing in the actual coax part.
 Minimum bending radius on inline cable is 100 mm.

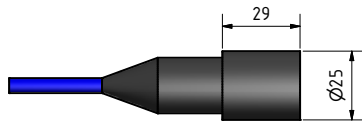

HF50CXILF

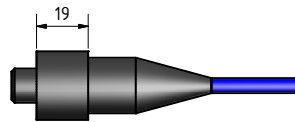

HF50CXILM

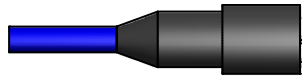
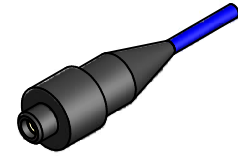

HF50CXIL6F



HF50CXIL6M

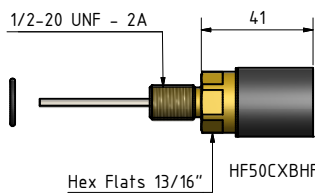
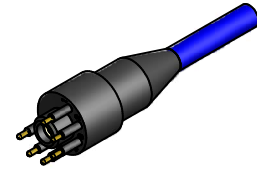

HF50CXBHF

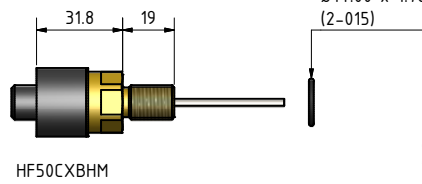

HF50CXBHM

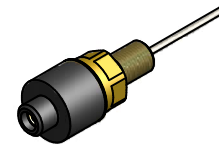

HF50CXBH6F

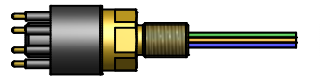

HF50CXBH6M

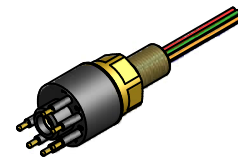

HF50CXDCF

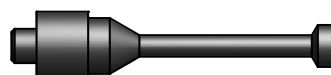

HF50CXDCM

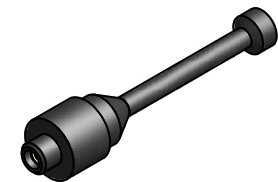

HF50CXDC6F



HF50CXDC6M

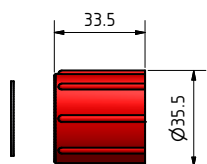
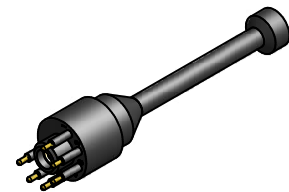

DLSA-F

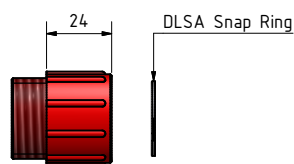

DLSA-M



Drawing information

Dimensions in mm (1 mm = 0.03937 inch)
Threads in inches (1 inch = 25.4 mm)