

SubConn® Ethernet Circular

Double O-ring, 8 and 13 contacts

Connector specifications

Voltage rating	600 V DC/AC rms (13 contacts only)
Voltage rating on data wire	250 V DC/AC rms
Current rating on power wire	4 A per contact (max 16 A per connector) (13 contacts only)
Data rate	1 Gbit/s
Insulation resistance	> 200 Mohm
Contact resistance	< 0.01 ohm
Wet matings	> 500
Temperature rating (water)	- 4 to 60°C, 25 to 140°F
Temperature rating (air)	- 40 to 60°C, - 40 to 140°F
Storage temperature rating	- 40 to 60°C, - 40 to 140°F
Qualified pressure tested	600 bar, 8,700 psi

Material specifications

Connector body	Chloroprene rubber
Bulkhead body	Brass, stainless steel, titanium, anodised aluminium
Contacts	Female sockets in gold plated brass UNS - C36000
	Male pins in gold plated beryllium copper
O-rings	Nitrile
Locking sleeves	POM or stainless steel
Snap rings	Stainless steel AISI 302
Bulkhead leads (3.3 ft, 100 cm)	CAT 5E patch cable, 5 x 20 AWG, 0.52 mm ² coloured PTFE (13 contacts only)
	incl. RJ 45 connector (not installed)

Face view (male)

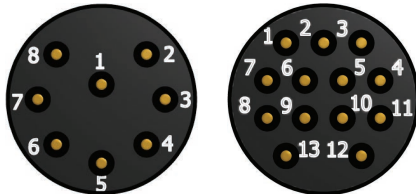



For more information
see page 74/75

DIL8F
DOM8F
DPB0F8F
DDC8F

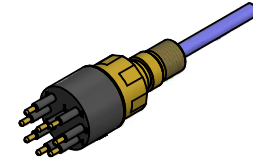
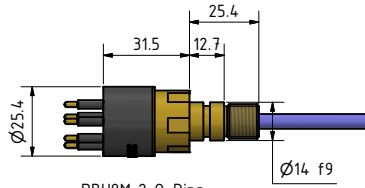

O-Ring
Ø10.82 x 1.78
(2-013)



For more information
see page 74/75

DIL8M
DOM8M
DPB0F8M
DDC8M

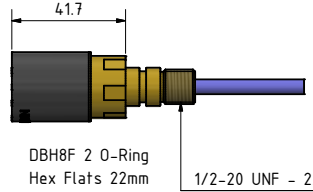

O-Ring
Ø15.6 x 1.78
(2-016)

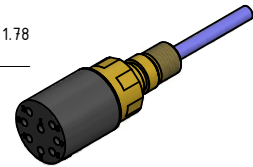

For more information
see page 76/77

DIL13F
DOM13F
DPB0F13F
DDC13F

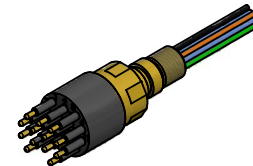

For more information
see page 76/77

DIL13M
DOM13M
DPB0F13M
DDC13M

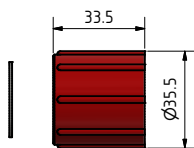
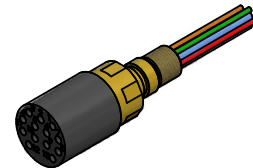

DLSA-F

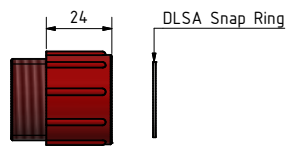

DLSA-M



Drawing information

Dimensions in mm (1 mm = 0.03937 inch)
Threads in inches (1 inch = 25.4 mm)